



OWNER'S MANUAL

LIFE PRESERVER SURVIVAL VEST

#485-CG (Automatic)

WARNINGS & CAUTIONS

The Life Preserver Survival Vest should not be worn by anyone under 110 lbs. or under 14 years of age.

If orally inflated, DO NOT ACTIVATE THE CO2 CYLINDER. Prior oral inflation will lead to excessive pressure, which may burst the flotation cell. Only use a 33-gram CO2 cylinder.

When replacing the CO2 cylinder, ensure that the armed auto-inflator indicators A thru D shown on Page 2 are visible. Failure to do so will cause the life preserver NOT TO INFLATE OR INFLATE WHEN REPLACING CO2 CYLINDER. Replacement of the inflator tablet (#5) is suggested whenever a CO2 cylinder is replaced.

The Life Preserver Survival Vest must be visually inspected prior to use, and functionally tested per inspection procedures.

Should the Life Preserver Survival Vest be immersed in either salt or chlorinated water, the vest MUST BE FRESH WATER WASHED. Failure to fresh water wash the vest may cause corrosion to the CO2 cylinder, firing arm, and firing pin, as well as damage to the fabric coatings.

DO NOT inflate the Life Preserver Survival Vest prior to jumping into the water, if you are more than three to four feet above the water. NEVER DIVE HEAD FIRST WITH THE VEST INFLATED. This could cause severe personal injuries and damage the life vest.

DO NOT inflate the Life Preserver Survival Vest below deck in a boat or ship as you may be trapped under water in a cabin, which has been flooded.

DESCRIPTION

The Life Preserver Survival Vest #485-CG is a compact, light weight, and comfortable to wear, manually activated CO2 inflatable life vest with an automatic backup inflator designed to provide flotation characteristics normally found in large, bulky, rigid-type life preservers. It produces a positive righting moment (face up) with 35 lbs. of buoyancy. The flotation cell is an encased design. The cell is simply repacked by deflating, folding under, and snapping in place. The automatic backup inflator will activate the CO2 bottle after approximately 2 seconds of immersion should the user fail to activate the vest manually. The vest is equipped with two (2) equipment pockets (6" x 5" x 1-7/8") for survival equipment or other small items and a strap for attachment of a survival knife (LSC #358). The pockets are positioned to produce the least amount of interference and to distribute the weight properly. A buddy line with a toggle is located beneath the left side of the flotation cell and is used to connect survivors together. The vest is bright orange with USCG markings, has a pile tape patch for strobe light placement, webbing for attachment of a PML, D-ring for attachment of a tether, and has retro-reflective tape on the shoulders for detection by rescue personnel.

NOTE

For part & indication identification, refer to the illustrations on Page two.

INSPECTION

While LSC has designed and manufactured the inflatable to be as reliable as possible, periodic testing and inspection are necessary to ensure functional reliability. The frequency of the inspection, especially with regard to the inflator tablet in the auto inflator, should be determined by the frequency and condition of use. However, prior to each use a visual inspection should be conducted. Additionally, a leak inspection of the vest and replacement of the inflator tablet should not exceed six (6) months.

VISUAL INSPECTION (Performed prior to each use)

Open the CO2 cover and ensure that the armed auto-inflator indicators A thru D are visible. Remove the CO2 cylinder (#3) and check the bottom for pin punctures in the seal of the cylinder. Discard the CO2 cylinder if punctured and install new cylinder (#3) fully into the inflator housing. Check the CO2 seating window (#2) for a green indication after cylinder installation. Ensure the beaded inflation lanyard is snapped to the vest.

Inspect the entire vest, fabric, webbing, hardware and other components for damage.

USING YOUR VEST

To don the Life Preserver Survival Vest, simply put the vest on the same way you would a coat. Close the front buckle, then zip up the front zipper of the vest. Adjust the waist belt to fit snugly by pulling the two side straps to the rear. Tuck the excess belt under the vest. Operating instructions are located on the left lobe inside panel. Should you have any questions concerning the use of your vest or its auto-inflator, please do not hesitate to call LSC.

Lift the fabric cover; unscrew the CO2 cylinder (#3) and check to ensure that it has not been punctured. Replace cylinder into the inflator housing and check the CO2 seating window (#2) for a green indication after cylinder installation. Red indicates a improperly seated CO2 cylinder. Additionally, ensure armed auto-inflator indications A thru D are visible.

The primary means to inflate the life vest is manually, using the beaded inflation lanyard (#1). To inflate manually, jerk the beaded lanyard (located on your left side) down and the cell will inflate. The automatic backup inflator is a backup device, which should inflate the vest. The automatic backup inflator will activate the CO2 bottle after approximately 2 seconds of immersion. Should the vest not inflate either manually or automatically, the wearer should inflate the vest using the oral inflation tube. To orally inflate the vest, simply unsnap the vest, pull the oral inflation tube out located on your right lobe, take the dust cover off, and blow into the tube until the vest is firm.

After inflation of the vest in the water, avoid body movement or wasteful expenditures of energy as much as possible and remain calm. Should the inflatable cell lose some buoyancy, remove the cap on the oral inflation tube and blow into it. Replace the cap on the oral inflation tube after you have topped-off the cell.

The automatic backup inflator will inflate the cell whenever exposed to water. Should the vest inadvertently inflate due to heavy rain or sea states, deflate the cell by depressing the top of the oral tube dust cover into the oral tube. Remove the CO2 cylinder (#3) and discard. Ensure the beaded inflation lanyard (#1) is in the full up (armed) position and insert a new green safety pin. Pull the spring-loaded lever (#4) up until it "clicks" and locks into place. Dry the inflator and inflator tablet case (#6). Install a inflator tablet (#5) into the tablet case (#6) and return spring loaded lever (#4) to its closed position. Install the new CO2 cylinder (#3) into housing until green indicator is visible. Ensure that the armed auto-inflator indications A thru D are visible.

LEAK INSPECTION (Performed Semiannually)

1. Inflate the bladder through the oral tube with a low-pressure air source (2 psi max.) or by oral inflation. CAUTION: DO NOT INFLATE BLADDER WITH REAR ZIPPER OPEN. DO NOT OVER INFLATE. Damage to the bladder will result from overpressure. After four (4) hours, recheck the bladder for pressure. If the bladder has lost pressure, recheck for leaks and replace the bladder if required. Deflate the bladder.
2. After deflation, install a new inflator tablet (#5) and reinstall charged CO2 cylinder (#3) using the steps contained in this manual. Close the CO2 cover and refold the bladder. Complete step listed in Visual inspection.

FUNCTIONAL & LEAK INSPECTION

(Performed Annually)

1. Pull beaded lanyard to inflate the bladder. Both sides of the bladder should fully deploy. Deflate the cell by depressing the top of the oral tube dust cover into the oral tube. Place inflation lanyard (#1) is in the full up (armed) position and insert a new green safety pin.
2. Complete steps 1 & 2 in Leak Inspection above.

FACTORY SUPPORT

Contact LSC for inspections and services, LSC will inspect and test your inflatable vest, LSC service #000-IS33.

REPLACEMENT PARTS

#470-CG	AUTO INFLATOR KIT	#471	TABLETS, INFLATOR (10 pack)
#470-1	PIN, SAFETY, GREEN	#353	CO2 CYLINDER, 17 GRAMS
#358	RESCUE & SURVIVAL KNIFE		

WARRANTY

LSC products are warranted to the first consumer purchaser to be free from defects in material or workmanship for a period of twelve (12) months. Please contact LSC for our complete Warranty information and Policies, or visit our website.

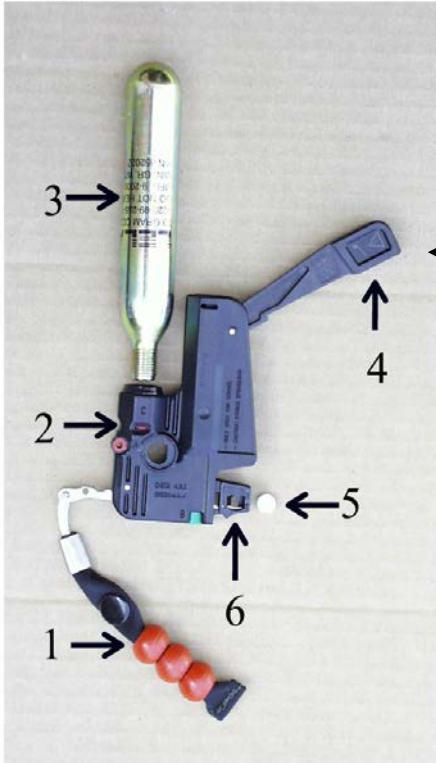

Parts Breakdown of CO2 Auto-Inflator

1. Beaded Inflation Lanyard
2. CO2 Seating Window
3. CO2 Cylinder, 17 Gram (#353)
4. Spring-loaded Cocking Lever in Open Position
5. Inflator Tablet (#471)
6. Inflator Tablet Case

Armed CO2 Auto-Inflator Indications

- A. Spring-loaded Cocking Lever in Closed Position
- B. Green Indicator Flush with Bottom Edge.
- C. Beaded Lanyard Armed with Safety Pin Installed.
- D. CO2 Cylinder Installed/Green Indicator in Window.

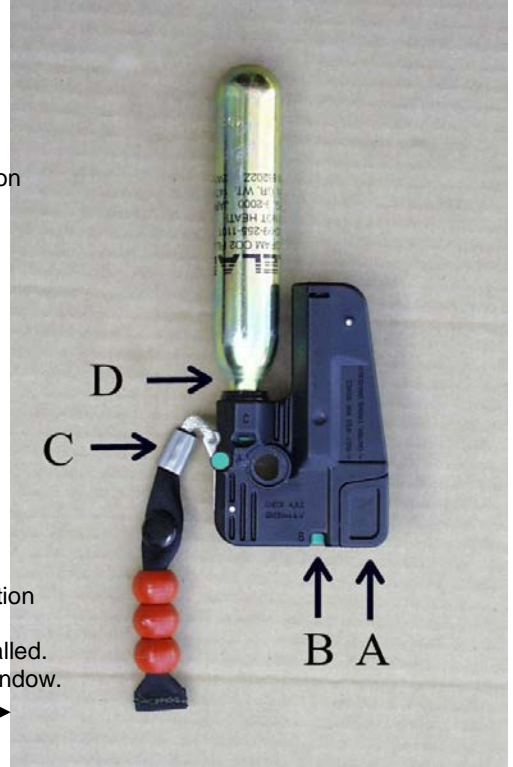

LIFESAVING SYSTEMS CORP.

220 ELSBERRY RD.
APOLLO BEACH, FL 33572
PHONE: 813/645-2748
FAX: 813/645-2768
www.lifesavingsystems.com